



Welcome Screen

Having a warm greeting message with Hotel name and its logo on the TV when customers enter their rooms will let them feel more welcomed and cared for. A little thing can make a big difference.



One Channel Map

One Channel Map feature allows users to edit and list the channels of their choice from any of the multiple broadcasting signals.

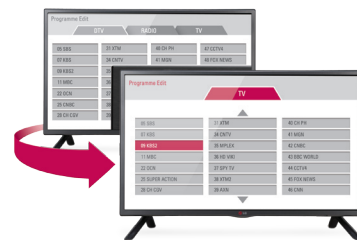

USB Auto Playback

LG Commercial TVs recognize playable contents in external storages and play them automatically.



Lock Mode

The Lock Mode blocks external input signals for illegal communication, a useful feature for preventing misuse of TVs in facilities such as prisons, mental hospitals and other applicable public spaces.

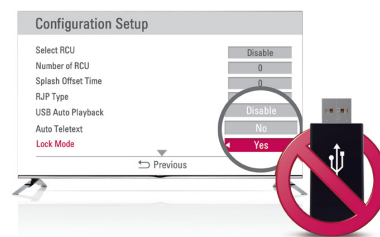

Commercial Lite

LY340C : 22H" / 28H" / 32H"

LY330C : 22H" / 28H" / 32H" / 39" / 42" / 47" / 55" / 60"

Specification

Video	Size	LY340C : 22H" / 28H" / 32H" LY330C : 22H" / 28H" / 32H" / 39" / 42" / 47" / 55" / 60"
	Resolution	1920 x 1080 (FHD) (28H"/32H" : 1366 x 768 (HD))
	XD Engine	•
	Real Cinema 24p (3:3 pull down)	•
Broadcasting System	Analog	• (PAL/SECAM)
	Digital	•
	Terrestrial	LY340C : DVB-T2 LY330C : DBV-T
	Cable	DVB-C
	Satellite	DVB-S2 (only for LY340C)
Audio	Audio Output	22H" / 28H" 5W + 5W 32H" / 39" / 42" / 47" / 55" / 60" 10W + 10W
	Speaker System	2.0 ch
	Sound Mode	• 6 modes (Standard, News, Music, Cinema, Sport, Game)
	Clear Voice	•
Feature	Smart Share - MHL	•
	HDMI-CEC	•
	HTNG-CEC 1.3	• (1.3)
	Hotel Mode / PDM / Installer Menu	•
	Smovie	•
	Lock mode	•
	IR Out	• (RS-232C)
	External Speaker Out	• (Int /Fixed, 3.5mm, Stereo, Single ended Type(GRD,L+,R+), 1W with 8Ω)
	RJP Interface	• (RS-232C, HDMI CEC)
	RJP Compatibility	• LG/Teledapt (RS-232C), Teledapt/Guestlink (HDMI CEC)
	USB	• (USB 2.0)
	USB Auto Play back	•
	Moving Picture Playback (SD/HD/Plus HD)	Divx HD
	Picture	JPEG
Audio Codec	MP3, AC3, MPEG, AAC,HEAAC, CDDA, LPCM	
USB Cloning	•	
One Channel Map / Logical Channel Map	•	
Multi IR Code	•	
Welcome Screen (Splash Image)	•	
Auto Off / Auto Sleep	•/•	
Smart Energy Saving	•	
Digital eye (light sensor)	• (Except 22H"/28H")	
Anti-theft System - Kensington Lock	•	
Interface	Headphone Out	• (Except 22H"/28H")
	HDMI In	1
	USB (2.0)	1
	CI Slot	1
	RF In	1
	Full Scart	1
	Component in (Y,Pb,Pr) + Audio	1(Phone Jack)
	Digital Audio Out (Coaxial / Optical)	1 (Optical)
	HDMI/HDCP Input	1
	RGB In (D-sub 15pin) - PC	1
PC Audio Input	1(Phone Jack & Component in one)	
RS-232C(D-Sub 9pin)	1	
LAN Port	1 (Only for LY340C)	
External Speaker Out(3.5mm phone jack)	1 (Spk-out 1)	
Power Consumption	Voltage, Hz	100 ~ 240V, 50/60Hz
	Max (Watts)	TBD
	Typical (Watts)	TBD
	Energy saving (Min)	TBD
	Energy saving (Med)	TBD
	Energy saving (Max)	TBD
	Stand-by	0.3W
Dimension	W x H x D (with bottom power lamp, mm)	22H" : 285.9 * 362.4 * 140.1 28H" : 352.0 * 447.9 * 182.1 32H" : 687 * 481 * 207 39" : 841 * 567 * 218 42" : 913 * 610 * 218 47" : 992 * 676 * 255 55" : 1185 * 772 * 255 60" : 1056 * 848 * 271
	Weight (with stand, Kg)	22H" : 3.1 28H" : 4.8 32H" : 6.2 39" : 8.3 42" : 9.5 47" : 12.7 55" : 18.4 60" : 23.5

Dimension

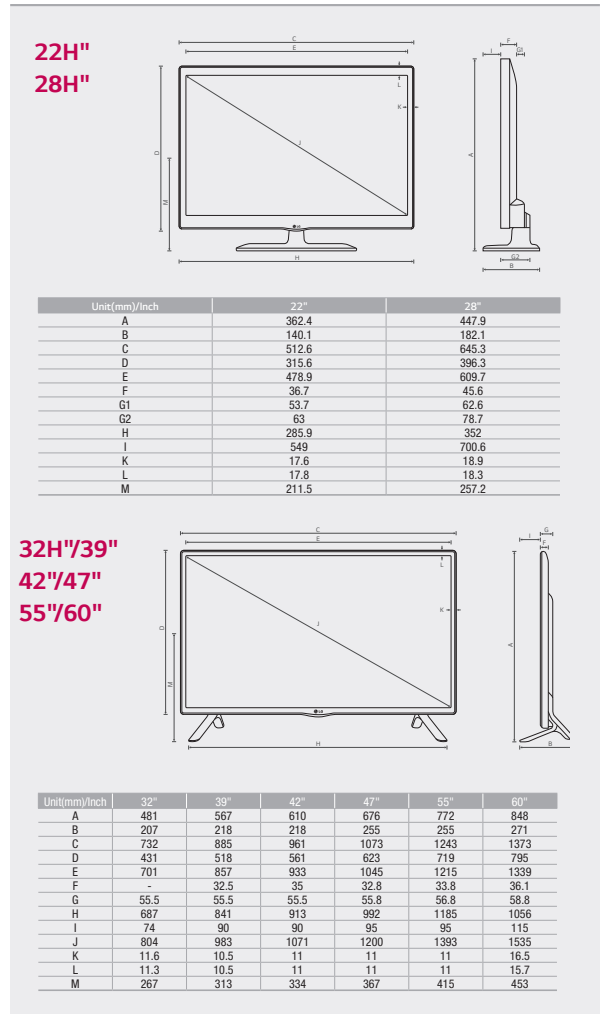

Rear Jack Panel

